



JT-720 Series



ST-725 Series



Series Model

- JT-720EA:125KHz Em Marin format
- JT-720MA:13.56MHz Mifare format
- JT-720MAF:13.56MHz Mifare SOCA format

* The specifications of both ST-725 and JT-720 series are the same except the position of the relay.

Special features

- 8 sets of door opening password available for user to set.
- External yellow light available for user to set.

- 1000-card capacity. Gray and White outer case available to select.
- Multiple water proof design to be able to install outdoors.
- JT-720 EA/MA provides 2 sets of external RELAY for door opening and siren.
- ST-725 EA/MA with built-in door opening RELAY.

Specification

- | | |
|--|---|
| <ul style="list-style-type: none"> • Power Supply : DC 12V \pm15% • Door control RELAY:
JT-720:External RELAY module
ST-725:Built-in RELAY • Frequency : 125KHz or 13.56MHz . • Door closing time: 00-99 seconds • Card capacity: 1000 • Operation mode : Standalone • Keyboard: 2\times6, 12 buttons. • Weight:JT-720:250 g (included wrapping)
ST-725:210 g (included wrapping). | <ul style="list-style-type: none"> • Power consumption: 100mA (standby); 130mA (operation)\pm5% • Fireproof polycarbonate material for outer casing . • Five door opening methods:
1. Password
2. Proximity card
3. Proximity card and password
4. Password or proximity card
5. Special system password • Input point: 1. Exit push button 2. Anti-theft detection 3. Door sensing input • Output point: 1. Door open connector 2. Alarm output |
|--|---|

Waterproof

【JT-720】

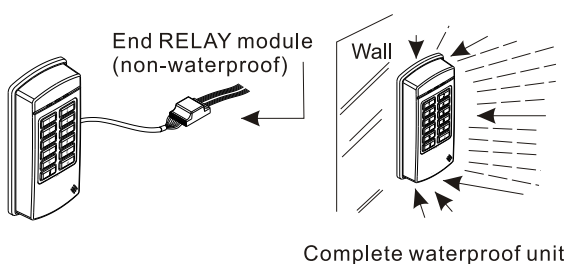

【ST-725】

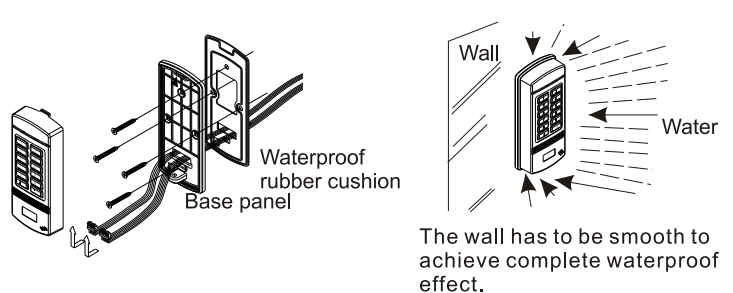

Structure diagram

