



ST-720 Series

ST-725 Series



## Series Model

- ST-720EA: 125KHz Em Marin format
- ST-720MA: 13.56MHz Mifare format
- ST-720MAF: 13.56MHz Mifare SOCA format

\* The specifications of both ST-725 and ST-720 series are the same except door bell connector and the position of the relay.

## Special features

- 1000-card capacity. Gray and White outer case available to select.
- Multiple water proof design to be able to install outdoors.
- ST-720 EA/MA provides 2 sets of external RELAY for door opening and siren.
- ST-725 EA/MA with built-in door opening RELAY.

- 8 sets of door opening password available for user to set.
- External yellow light available for user to set.

## Specification

- Power Supply : DC 12V  $\pm$ 15%
- Door control RELAY:  
ST-720:External RELAY module  
ST-725:Built-in RELAY
- Frequency : 125KHz or 13.56MHz .
- Door closing time: 00-99 seconds
- Card capacity: 1000
- Operation mode : Standalone
- Keyboard: 2 $\times$ 6, 12 buttons.
- Weight :ST-720:250 g (included wrapping)  
ST-725:210 g (included wrapping).

- Power consumption: 100mA (standby); 130mA (operation)  $\pm$ 5%
- Door bell connector: only available for ST-720 series.
- Fireproof polycarbonate material for outer casing .
- Five door opening methods:  
1. Password  
2. Proximity card  
3. Proximity card and password  
4. Password or proximity card  
5. Special system password
- Input point: 1. Exit push button    2. Anti-theft detection    3. Door sensing input
- Output point: 1. Door open connector    2. Alarm output

## Waterproof

### 【ST-720】

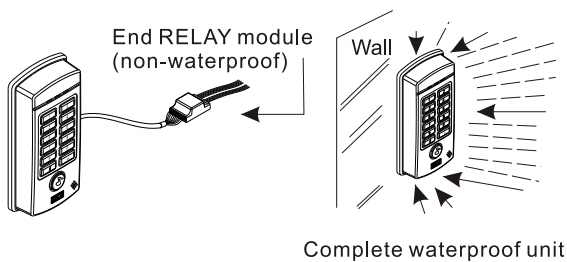

### 【ST-725】

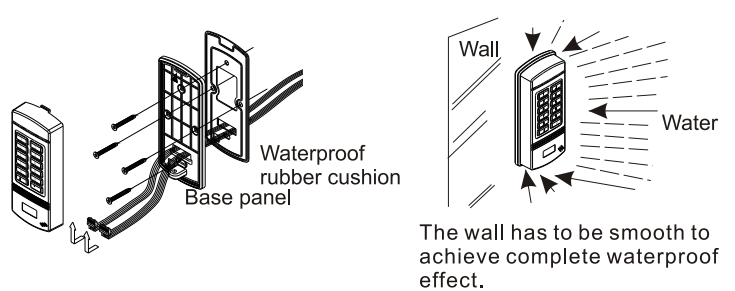

## Structure diagram

